

## REFERENCES



- Anthony, R.N. and Young, D.W. (1994) Management Control in Nonprofit Organizations, Richard D. Irwin, Inc 5<sup>th</sup> edition, World Health Organization, Geneva, Switzerland.
- Carrin, G. and Elvo, K. (1995) A Methodology for the Calculation of Health Care Cost and their Recovery, World Health Organization, Switzerland.
- Carrin, G., Pierrot, J. and Sergent, F. (1994) The Influence of Financial Participation by the Population on the Demand for Health Care, World Health Organization, Geneva, Switzerland.
- Creese, A. and Parker, D. (1993) Cost Analysis in Primary Health Care, a Training Manual for Managers, World Health Organization, Geneva, Switzerland.
- Gertrud, S. E. and Sophal, O. (1996) Policy and Strategy Development for Health Financing in the Kingdom of Cambodia, a Institute of Public Health.
- MOC (1997) Cambodia, the Reemergence of Opportunities, Business and Investment Book, Ministry of Commerce, Phnom Penh, Cambodia.
- MOH (1996), The National Charter on Health Financing in the Kingdom of Cambodia, Health Economic Task Force, Ministry of Health and World Health Organization, Phnom Penh, Cambodia.

NBOC (1997) Economics and Monetary Statistics Reviews, National Bank of Cambodia.

Philips, M. and others (1993) Guidelines for Cost-Effectiveness Analysis of Vector Control, PEEM Secreteriat, World Health Organization, Geneva, Switzerland.

Pirom, K. and others (1991) Unit Cost of Diagnostic Imaging Tests at the Outpatient Department in Chulalongkorn Hospital, Thailand.

Planning Unit (1996) Cambodia Health Care Report, Ministry of Health, Phnom Penh, Cambodia.

RAND Cooperation (1992) Unit Cost Analysis, a Manual for Facility Administrators And Policy maker, RAND, Santa Monica, Indonesia.

Sephard, D. and others (1997) Analysis of Hospital Costs, A Manual for Managers, World Health Organization, Geneva, Switzerland.

Weaver, M. and others (1994) Prospects for Reform of Hospital Fees in sub-Saharan Africa, a Case Study of Niamey National Hospital in Niger, Social Science and Medicine.

Zaman, S. and others (1993) Cost Analysis for Hospital Care, the case of Embaba Hospital, Cairo, Egypt, Health Financing and Sustainability Project, Bethesda, Maryland.

## APPENDIX A

**Table A.1: Conversion of Capital Cost from Foreign Currency to Local Currency**

1 dollar (\$) = 2700 riels (R), exchange in 1997

No	Items	Cost(\$)	Exchange rate	Cost(R)
<b>Pediatrics</b>				
1	Aspirator Ambu, foot operated	197.26	2700	532602
2	Autoclave vertical	75	2700	202500
3	Baby scale	53	2700	143100
4	Hospital hammock	268	2700	723600
5	Chariot roulante inox	441.76	2700	1192752
6	Hospital beds	1200	2700	3240000
7	Laryngoscope	70	2700	189000
8	Otoscope	31.5	2700	85050
9	Obus oxygene+manometre	240	2700	648000
10	Stand for perfusion	352	2700	950400
11	Resuscitateur	151.79	2700	409833
12	Examination table	257	2700	693900
13	Infant tensiometre	33.6	2700	90720
14	Shallow tray	12.5	2700	33750
15	Tray with cover	6.16	2700	16632
16	Bassin Kidney	11.5	2700	31050
17	Bed bassin	25.65	2700	69255
18	Drum sterilization	10.8	2700	29160
19	Inox box for 4 seringes	30.48	2700	82296
20	White board	25	2700	67500
21	Wardrobe	40	2700	108000
22	Writing desk	50	2700	135000
23	Chair	60	2700	162000
24	Bed utility	50	2700	135000
25	Folding screen	120	2700	324000
26	Table	35	2700	94500
27	Stool	50	2700	135000
28	Stove kerogene	19.7	2700	53190
<b>General medicine</b>				
1	Adult scale	132	2700	356400
2	Brancart pliante	76.83	2700	207441
3	Chariot roulante inox	220.88	2700	596376
4	Hospital bed	2100	2700	5670000
5	Otoscope	31.5	2700	85050
6	Kidney bassin	23	2700	62100
7	bed bassin	25.65	2700	69255
8	Box aluminium for 4 seringes	15.24	2700	41148
9	Drum sterilization	10.8	2700	29160
10	Shallow tray	12.5	2700	33750
11	Stand for perfusion	352	2700	950400
12	Examination table	257	2700	693900
13	Adult tensiometre	30.2	2700	81540
14	White board	50	2700	135000
15	Wardrobe	40	2700	108000
16	Writing desk	50	2700	135000
17	Chair	120	2700	324000
18	Bed utility	50	2700	135000

Table A.1 (Continued)

No	Items	Cost(\$)	Exchange rate	Cost(R)
19	Folding screen	240	2700	648000
20	Table	70	2700	189000
21	Stool	100	2700	270000
<b>Gyneco-obstetric</b>				
1	Mucus aspirator foot operated	197.26	2700	532602
2	Vertical autoclave	75.00	2700	202500
3	Adult scale	132.00	2700	356400
4	Baby scale	116.40	2700	314280
5	Baby scale suspend	32.91	2700	88857
6	Hospital hamox	1340.00	2700	3618000
7	Bock laveur+ tuyaux canule	14.52	2700	39204
8	clamp ombilical inox	26.60	2700	71820
9	chariot roulant	220.88	2700	596376
10	Cranioclaste de Braum	9.65	2700	26055
11	Cuvette de toilette	9.82	2700	26514
12	Extractor a vide type Malmstrom	509.23	2700	1374921
13	Aspirator Aesculap	50.20	2700	135540
14	Forceps obstetrical Tamier	9.30	2700	25110
15	Patient bed	600.00	2700	1620000
16	Dilatation kit	121.00	2700	326700
17	Metre ruban 1.5/60 coton	0.43	2700	1161
18	Oxygene bil+detendeur	300.00	2700	810000
19	Pehimetre type collyer	5.69	2700	15363
20	Perce crane Smellie 27cm	9.50	2700	25650
21	Stand for perfusion	176.00	2700	475200
22	Resuscitateur adult	151.79	2700	409833
23	dressng set	132.00	2700	356400
24	Obstetrical stestoscope	24.30	2700	65610
25	Delivery table	478.00	2700	1290600
26	Examination table	257.00	2700	693900
27	Stove kerosene	19.70	2700	53190
28	Kidney bassin	9.20	2700	24840
29	Bed bassin	25.65	2700	69255
30	Box aluminium for 4 seringes	15.24	2700	41148
31	Shallow tray	12.50	2700	33750
32	Tray with cover	10.32	2700	27864
33	Drum sterilisation	5.40	2700	14580
34	Tensiometre	30.20	2700	81540
35	White board	25.00	2700	67500
36	Wardrobe	40.00	2700	108000
37	Writing desk	50.00	2700	135000
38	Chair	30.00	2700	81000
39	Bed utility	50.00	2700	135000
40	Folding screen	60.00	2700	162000
41	Table	35.00	2700	94500
42	Stool	25.00	2700	67500
<b>Operating room</b>				
1	Mucus aspirator foot operated	197.26	2700	532602
2	Anesthesia machine	1661	2700	4484700
3	Autoclave universale	1750	2700	4725000
4	Electric aspirator	1200	2700	3240000

**Table A.1 (Continued)**

No	Items	Cost(\$)	Exchange rate	Cost(R)
5	Brancard portatif demonte	367.63	2700	992601
6	Bistori electrique	2500	2700	6750000
7	Chariot roulant inox	220.88	2700	596376
8	Laryngoscope Jeu de 3 lames	70	2700	189000
9	Lamp scialytique	2413	2700	6515100
10	Lamp scialytique roulante	468	2700	1263800
11	Stand for drum	144.42	2700	389934
12	Support cuvette socle	78.47	2700	211889
13	Support obus	116	2700	313200
14	Negatoscope	508	2700	1371600
15	Operation table	1180	2700	3186000
16	Drum Inox	77.97	2700	210519
17	Anesthesia moving table	87.1	2700	235170
18	Instrumentif table Mayo	63.9	2700	172530
<b>Surgery</b>				
1	Vertical autoclave	75	2700	202500
2	Boite cesarienne	250	2700	675000
3	Boite hysterectomie	665	2700	1795500
4	Boite laparotonmie	994	2700	2683800
5	Boite amputation	400	2700	1080000
6	Brancard pliante	76.83	2700	207441
7	Chariot roulante inox	220.88	2700	596376
8	Patient bed	1200	2700	3240000
9	Box for small surgery	560	2700	1512000
10	Oxygene etendeur	300	2700	810000
11	Stand for perfusion	440	2700	1188000
12	Stove kerosene	19.7	2700	53190
13	Kidney bassin	23	2700	62100
14	bed bassin	25.65	2700	69255
15	Shallow tray	12.5	2700	33750
16	Tray with cover	5.16	2700	13932
17	Drum sterilisation	10.8	2700	29160
18	Tensiometre	30.2	2700	81540
19	Examination table	257	2700	693900
20	White board	50	2700	135000
21	Ward table	40	2700	108000
22	Writing desk	50	2700	135000
23	Chair	120	2700	324000
24	Bed utility	50	2700	135000
25	Folding screen	240	2700	648000
26	Table	70	2700	189000
27	Stool	100	2700	270000
<b>Laboratory</b>				
1	Anse de plaine	3.5	2700	9450
2	Balance laboratory	350	2700	945000
3	Ballon a font plat	7	2700	18900
4	Ballon a font plat	11	2700	29700
5	Kidney bassin	4.6	2700	12420
6	becher	3	2700	8100
7	Boite range lames	42	2700	113400
8	Cellule de Nageotte	34	2700	91800

**Table A.1 (Continued)**

No	Items	Cost(\$)	Exchange rate	Cost(R)
9	Cellule de Neubauer	40	2700	108000
10	Centrifugeur de table	1300	2700	3510000
11	Centrifugeur d'hematocrite	1300	2700	3510000
12	Compteur mecanique	104	2700	280800
13	Compteur mecanique de table	560	2700	1512000
14	Cuve a coloration	10	2700	27000
15	Entonnoir	42	2700	113400
16	Eprouvette	3	2700	8100
17	Eprouvette	4	2700	10800
18	Eprouvette	8	2700	21600
19	Water filter	100	2700	270000
20	Fiaule jaugee 100ml	5	2700	13500
21	Fiaule jaugee 500ml	10	2700	27000
22	Flacon compte-goutte	9	2700	24300
23	Flacon pour conservation	20	2700	54000
24	Goupillon pour tubes a essai	10	2700	27000
25	Goupillon pour tubes a hemolyse	2	2700	5400
26	Hemoglobine de Salhi	28	2700	75600
27	Lampe a alcool	11	2700	29700
28	Microscope olympis	1100	2700	2970000
29	Minuteur mecanique de table	36	2700	97200
30	Mortier+pilon	36	2700	97200
31	Pince a lame	20	2700	54000
32	Regle de lecture hematocrite	135	2700	364500
33	Calculator	5	2700	13500
34	white board	25	2700	67500
35	Wardrobe	40	2700	108000
36	Chair	6	2700	16200
37	Table	70	2700	189000
<b>Pharmacy</b>				
1	Glaciere 27 litres	93	2700	251100
2	Refrigerateur keros	1375	2700	3712500
3	Etagere en bois	100	2700	270000
4	Calculator	5	2700	13500
5	White board	25	2700	67500
6	Wardrobe	40	2700	108000
7	Writing desk	50	2700	135000
8	Chair	12	2700	32400
9	Table	35	2700	94500
<b>Kitchen</b>				
1	Casseroles 21	70	2700	189000
2	Couscoussier 501	316	2700	853200
3	Couverts patients	170	2700	459000
4	Faitout 41	34	2700	91800
5	Faitout 231	66	2700	178200
6	Lot materiel cuisine	80	2700	216000
7	Bed utility	100	2700	270000
<b>Building</b>				
1	From GTZ	143147.85	2700	386499195

Table A.1 (Continued)

No	Items	Cost(\$)	Exchange rate	Cost(R)
<b>Reunion</b>				
1	Retroprojector + screen	500	2700	1350000
2	White board	50	2700	135000
3	Wardrobe	80	2700	216000
4	Long chair	20	2700	54000
5	Chair	180	2700	486000
6	Table	350	2700	945000
<b>Guarde service</b>				
No	Items	Costs (\$)	Exchange rate	Costs (R)
1	White board	25	2700	67500
2	Wardrobe	80	2700	216000
3	Writing desk	100	2700	270000
4	Chair	60	2700	162000
5	Bed utility	100	2700	270000
6	Folding screen	30	2700	81000
7	Hanger dress	5	2700	13500
<b>Administration</b>				
No	Items	Costs (\$)	Exchange rate	Costs (R)
1	Calculator	20	2700	54000
2	Typing machine	600	2700	1620000
3	Repro.stencil	500	2700	1350000
4	White board	100	2700	270000
5	Wardrobe	160	2700	432000
6	Chair	60	2700	162000
7	Writing desk	200	2700	540000
8	Radio communication	1100	2700	2970000
9	Bicycle	200	2700	540000
10	Generator20kvadiesel	5800	2700	15660000
11	Generator 5kw	1000	2700	2700000
12	Vehicle	200000	2700	540000000
13	Moto supervisor 70cc	7000	2700	18900000
14	Water tape	508	2700	1371600
15	Regulator tension 125 A	1800	2700	4860000
16	Public address system	500	2700	1350000
<b>Radiology</b>				
No	Items	Costs (\$)	Exchange rate	Costs (R)
1	X-ray machine	5476	2700	14785200
2	Alphabet en plomb	60	2700	162000
3	cuve development film	53.45	2700	144315
4	Carte porte film 18x24	86	2700	232200
5	Carte porte film 30x40	104	2700	280800
6	Carte porte film 35x43	110.5	2700	298350
7	Cassette film 18x24	315	2700	850500
8	Cassette film 30x40	377.25	2700	1018575
9	Cassette film 35x43	345.5	2700	932850
10	Gant protector	20.6	2700	55620
11	Negatoscope	508	2700	1371600

**Table A.1 (Continued)**

No	Items	Cost(\$)	Exchange rate	Cost(R)
12	Lunette protector	45	2700	121500
13	Stylo test	35.25	2700	95175
14	Tablier protector	35	2700	94500
<b>Consultation</b>				
1	Adult scale	132	2700	358400
2	Otoscope	31.5	2700	85050
3	Tensiometre for adult	30.2	2700	81540
4	Tensiometre for infant	33.6	2700	90720
5	Speculum nasal	4.12	2700	11124
6	White board	25	2700	67500
7	Wardrobe	80	2700	216000
8	writing desk	50	2700	135000
9	Chair	24	2700	64800
10	Long Chair	30	2700	81000
11	Folding screen	30	2700	81000
12	Stool	5	2700	13500
13	Dental set 1: DS1 B	192.62	2700	520074
14	Dental set 2: DS2 B	95	2700	258500
15	Dental set 3: DS3 B	100.49	2700	271323
16	Dental set 4: DS4 B	59.96	2700	161892
17	Dental set 5: DS5 B	50	2700	135000
18	Dental set 6: DS6 B	780.46	2700	2107242











**Table A.3: Assignment of Salary and Bonus before Giving Incentive to the Personnel**

Salary and Bonus of personnel per year who response for many activities

No	Personnel	Nb of staff	Salary per month	Salary per year	Bonus per year	Subtotal
1	Director	1	38000	456000	10000	466000
2	Vice director 1	1	38000	456000	10000	466000
3	Vice director 2	1	38000	456000	10000	466000
4	Doctor A	1	32100	385200	10000	395200
5	Doctor B	1	32100	385200	10000	395200

According to the personnel above are responsible for 2 or 3 activities in the hospital the table below showed their salaries and bonus that should be assigned to the service where they shared with.

No	Personnel	Salary to be assigned	Cost center														
			Adm.		Emergency		Gynico.obs.		Surgery		General med.		Pediatric		Consultation		
			Activi	Cost	Acti.	Cost	Acti.	Cost	Acti.	Cost	Acti.	Cost	Acti.	Cost	Acti.	Cost	
1	Director	466000	50%	233000	30%	139800										20%	93200
2	Vice Director 1	466000	30%	139800			50%	233000								20%	93200
3	Vice Director 2	466000	30%	139800					50%	233000						20%	93200
4	Doctor A	395200									80%	316160				20%	79040
5	Doctor B	395200											80%	316160	20%	79040	

By interviewing the first vice director of the hospital he said that he could not clarify exactly about working hours of the 5 personnel above. However he provided some information that can help this study to estimate how many percentage that they shared to others cost center:

- Director, most of the time he works at administration unit, partly works at emergency unit and one day per week works at consultation unit.
- First vice director, most of the time he works at gyneco-obstetric unit, partly help director at administration unit and one day per week work at consultation unit.
- Second vice director, most of the time he works at surgery unit, partly help director in admin unit and one day per week works at consultation unit.
- Doctor A, he is responsible for general medicine unit and one day per week works at consultation unit.
- Doctor B, he is responsible for pediatric unit and one day per week works at consultation unit.

**Table A.4: Salary and Bonus of the Personnel in each Division**

Personnel	No of Staff	Salary/month per person	Salary/year	Bonus	Subtotal/year
<b>Administration</b>					
Director					233000
1st Vice Director					139800
2nd Vice director					139800
Medical assist.	1	32100	385200	10000	395200
Staff	7	24700	2074800	70000	2144800
Driver	1	20600	247200	10000	257200
					<b>3309800</b>
<b>Guard</b>	3	20600	741600	30000	<b>771600</b>
<b>Kitchen staff</b>	2	3000	72000	20000	<b>92000</b>
<b>Cleaner</b>	4	3000	144000	40000	<b>184000</b>
<b>Laundry staff</b>	4	3000	144000	40000	<b>184000</b>
<b>General medicine</b>					
Doctor A					316160
Nurse 2	4	27000	1296000	40000	1336000
Nurse 1	3	24700	889200	30000	919200
Ancilliary	1	20600	247200	10000	257200
					<b>2828560</b>
<b>Pediatric</b>					
Doctor B	1				316160
Nurse 2	3	27000	972000	30000	1002000
Nurse 1	2	24700	592800	20000	612800
Ancilliary	1	20600	247200	10000	257200
					<b>2188160</b>
<b>Emergency</b>					
Director					139800
Nurse 2	4	27000	1296000	40000	1336000
Nurse 1	1	20600	247200	10000	257200
					<b>1733000</b>
<b>Gyneco-obstetric</b>					
1st Vice director					233000
Midwife 1.1	2	27000	648000	20000	668000
Midwife 1	3	22000	792000	30000	822000
Ancilliary	4	20600	988800	40000	1028800
					<b>2751800</b>
<b>Surgery</b>					
2nd Vice Director					233000
Surgical tech.2	2	32100	770400	20000	790400
Nurse 1.1	1	27000	324000	10000	334000
Surgical tech.1	6	24700	1778400	60000	1838400
					<b>3195800</b>
<b>Laboratory</b>					
Tech.labo. 1	3	24700	889200	30000	919200
Ancilliary	1	20600	247200	10000	257200
					<b>1176400</b>
<b>Radiology</b>					
Techni.Rx 1.1	1	27000	324000	10000	334000

**Table A.4 (Continued)**

Personnel	Nb of staff	Salary/month per person	Salary/year	Bonus	Subtotal/year
<b>Pharmacy</b>					
Pharm.assist	1	24300	291600	10000	301600
Nurse 1.1	1	27000	324000	10000	334000
Nurse 1	2	24700	592800	20000	612800
Ancilliary	1	20600	247200	10000	257200
					<b>1505600</b>
<b>Consultation</b>					
Director					93200
1st Vice Director					93200
2nd Vice Director					93200
Doctor A					79040
Doctor B					79040
Dentist assist.	1	24300	291600	10000	301600
Nurse 1.1	1	27000	324000	10000	334000
Nurse 1	1	24700	296400	10000	306400
					<b>1379680</b>

**Table A.5: Assignment of Drug Cost**

to be assigned for outpatient and inpatient department

Following the first vice director of the district hospital said that a majority of the oral drugs used for OPD and a small part used for IPD. For IPD used totally injection drugs. So we assumed that 20% of the oral drug used for IPD

Patient service	Cost of drugs to be allocated	Proprtion(%)	Subtotal (Riel)
For OPD and IPD	118779581		
For OPD		80	95023665
For IPD		20	23755916

Total drug cost used for OPD                      95023665 riels

Total drug cost used for IPD                      87907471 riels

The next pages attached herewith were the cost of drugs in each trimester



**Table A.6: Drug Cost**

No	Items	Unit	Costs (R)
<b>1st trimester</b>			
<b><i>For in patient and outpatient department</i></b>			
1	Acetyl salicylic acid 300mg	Tablet	20650
2	Aluminium hydroxyde 500mg	-	5000
3	Amoxilline 250mg	Gellule	288000
4	Chloramphenicol 250mg	Capsule	136000
5	Cotrimoxazole 100+20mg	Tablet	108000
6	Cotrimoxazole 400+80mg	-	400000
7	Diazepam 5mg	-	10000
8	Erythromicine 250mg	-	21600
9	Ferrosulfate+folic acid	-	35000
10	Indometacine 25mg	-	21000
11	Mefloquine 250mg	-	226000
12	Methyldopa 250mg	-	41000
13	Metronidazol 250mg	-	57000
14	Ovrette blister	-	220000
15	Paracetamol 100mg	-	80000
16	Paracetamol 500mg	-	207000
17	Prednisolone 5mg	-	4000
18	Quinine sulfate 500mg	-	320000
19	Tetracycline 250mg	-	112000
20	Ampicilline 500mg	Capsule	76000
21	Benzoate acid 6%+acid sali.	Pot	76125
22	Benzoate benzyl 25% 1l	Lotion	56180
23	Chlorex 1,5%+cetrim. 15%	Flacon	68530
24	Gentian violet 25g	Flacon	5900
25	Iode polyvidone 10% 200ml	Flacon	33154
26	Bandage crepe	Rol.	26250
27	Bandage gauze non-sterilr	Rol.	174000
28	Gauze compress parafine	Impre	24600
29	Gauze rolis	Rol.	342090
30	Glove examination non-sterile	Packet	36000
31	Cotton wool 500gr	Rol.	93800
32	Medical bag plastic	-	228000
			<b>3552879</b>
<b><i>For inpatient department</i></b>			
1	Calcium gluconate	Amp	7650
2	Chloramphenicol 1g	Flacon	288000
3	Dexamethasone 4mg	Amp	5600
4	Dextrose 50% 20ml	-	52500
5	Solvent for injection	-	224000
6	Furosemide 20mg/2ml	-	28000
7	Hydralazine 20mg	-	39500
8	Metronidazol 500mg	Flacon	692500
9	Penicilline injection	Flacon	120600

Table A.6 (Continued)

No	Items	Unit	Costs (R)
10	Quinine dihydro. 500mg	Amp	44000
11	Dextrose 5% 500ml+set	Bottle	204000
12	Dextran 40 +set	-	566250
13	NSS 0,9% 1000ml	-	140000
14	Ringer lactate + set 1000ml	-	191300
15	Chloramine 500mg	Tablet	92000
16	Blades for surgical knife #15	Piece	6900
17	Blades for surgical knife #20	-	13800
18	Catheter foley ch8	Piece	59160
19	Catheter foley ch12	-	33500
20	Catheter foley ch14	-	33500
21	Catheter IV 18G	-	61000
22	Catheter IV 20G	-	61000
23	Catheter IV 22G	-	61000
24	IUD copper T	Piece	75000
25	Scalp vein 18-20G	-	5790
26	Scalp vein 21-23G	-	11000
27	Scalp vein 25G	-	22000
			<b>3139550</b>
<b>2nd trimester</b>			
<b><i>For in patient and outpatient department</i></b>			
1	Acetyl salicylic acid 300mg	Tablet	161070
2	Amoxilline 250mg	Gellule	656343
3	Chloramphenicol 250mg	Capsule	15403268
4	Cimetidine 200mg	Tablet	20479059
5	Cloxacilline 250mg	-	30530724
6	Cotrimoxazole 100+20mg	-	612000
7	Cotrimoxazole 400+80mg	-	1040000
8	Diazepam 5mg	-	40000
9	Erythromicine 250mg	-	1124463.72
10	Mefloquine 250mg	-	226000
11	Metronidazol 250mg	-	494000
12	Multivitamines	-	96298
13	Niclosamide 500mg	-	15404.25
14	O.R.S	Sachet	2837918.04
15	Paracetamol 100mg	Tablet	176000
16	Paracetamol 500mg	-	575000
17	Phen Meth Penicilline 250mg	Tablet	520561.8
18	Phenibarbital 665mg	-	12055.5
19	Prednisolone 5mg	-	7897.87
20	Promethazine 25mg	-	117262.52
21	Quinine sulfate 300mg	-	80000
22	Tetracycline 250mg	-	28000
23	Benzoate acid 6%+acid sali.	Pot	111650
24	Benzoate Benzil 90% 1L	Lotion	112360
25	Gentian violet 25g	Flacon	27730
26	Oxyde de zinc 10% 500mg	Pot	58775
27	Iode polyvidone 10% 200ml	Flacon	33154

Table A.6 (Continued)

No	Items	Unit	Costs (R)
28	Tetracycline 1% 5g	Tube	127698.88
29	Adhesive Tape zinc Oxide	Rol.	208811.03
30	Bandage crepe	Rol.	64913.18
31	Bandage gauze non-sterilr	Rol.	120915
32	Cotton wool 500gr	Rol.	243341.8
33	Gauze compress parafine	Impre	49050.21
34	Gauze 90cmx91m	Rol.	923442.28
35	Glove examination non-sterile	Packet	56013.79
36	Medical bags plastic	Piece	380000
			<b>77751180.87</b>
<b>2nd trimester</b>			
<b>For inpatient department</b>			
1	Ampicilline 500mg	Flacon	2100000
2	Calcium gluconate 10%	Amp	23871.3
3	Chloramphenicol 1g	Flacon	192888
4	Dextrose 50% 20ml	-	75000
5	Diazepam 10mg/2ml	Amp	39000.69
6	Solvent for injection	-	160000
7	Hydralazine 20mg	-	164490.6
8	Hydrocortisone 100mg/2ml	-	212747.6
9	Metronidazol 500mg	Flacon	169717.63
10	Oxytocine 10IU/ml	Amp	32674.97
11	Penicilline injection	Flacon	315764
12	Penicilline procaine+Pen.G	Vial	266500
13	Quinine dihydro. 500mg	Amp	22000
14	Dextrose 5% 500ml+set	Bottle	3098488.54
15	Dextran 40 +set	-	2831250
16	NSS 0,9% 1000ml	-	382400
17	Ringer lactate + set 500ml	-	204000
18	Ringer lactate + set 1000ml	-	2082425
19	Blades for surgical knife #15	Piece	7219.91
20	Blades for surgical knife #20	-	14439.81
21	Catheter foley ch12	Piece	33500
22	Catheter foley ch14	-	33500
23	Catheter IV 18G	-	142411
24	Catheter IV 20G	-	121725
25	Catheter IV 22G	-	121725
26	Condoms 48mm	Piece	200000
27	Glove surgical sterile/reus 7	-	135250
28	Glove surgical sterile/reus 6.5	-	67007.15
29	Glove surgical sterile/reus 7.5	-	59845.76
30	Needle suture cutting assorted	Piece	19034.22
31	Needle suture curved diff.size	Piece	7790.4
32	Scalp vein 21-23G	-	13610.83
33	Scalp vein 25G	-	18217.2
34	Suture catgut	-	90000
35	Suture vicryl 3/0-30cm	-	340270
36	Black silk 3-0	Packet	40185

Table A.6 (Continued)

No	Items	Unit	Costs (R)
37	Suture vicryl 2/0-70cm	Piece	606205.31
38	Black silk 2-0	Packet	40185
39	Talc 1kg		68975.48
40	Tape umbilical non- sterile	Rol.	546108.27
41	Tape test for autoclave	Rol.	160740
42	Developer 5l	Packet	153159
			<b>15414322.67</b>
<b>3rd trimester</b>			
<b>For in patient and outpatient department</b>			
1	Acetyl salicylic acid 300mg	Tablet	261821.28
2	Aminophilline 100mg	-	16659.4
3	Amoxilline 250mg	Gellule	903644.37
4	Chloramphenicol 250mg	Capsule	154032.68
5	Chlopromazine 25mg	Tablet	42454.6
6	Cimetidine 200mg	-	477844.71
7	Cloxacilline 250mg	-	76326.81
8	Cotrimoxazole 100+20mg	-	693000
9	Cotrimoxazole 400+80mg	-	840000
10	Ergometrine Methyl 0,125mg	-	56000
11	Folic acid 5mg	-	9000
12	Furosemide 40mg	-	38738.51
13	Indometacine 25mg	-	42000
14	Mefloquine 250mg	-	226000
15	Methyldopa 250mg	-	68750
16	Metronidazol 250mg	-	336245.26
17	Multivitamines	-	33704.3
18	Niclosamide 500mg	-	6161.7
19	Nystatine 100000UI	Ovule	127774.26
20	O.R.S	Sachet	2738920
21	Paracetamol 100mg	Tablet	292345.6
22	Paracetamol 500mg	-	859302.6
23	Phen Meth Penicilline 250mg	Tablet	331266.6
24	Promethazine 25mg	-	93810.02
25	Quinine sulfate 300mg	-	126448.8
26	Tetracycline 250mg	-	26572.52
27	Vitamine B1 250mg	-	245490.48
28	Benzoate acid 6%+acid sali.	Pot	269494.38
29	Benzoate Benzil 90% 1L	-	40600
30	Chlorex 1.5%+cetrim 15% 5l	Flacon	34265
31	Gentian violet 25g	-	213355
32	Iode polyvidone 10% 200ml	-	73758.15
33	Prednisolone acet.coll 0.5%	-	83200
34	Tetracycline 1% 5g	Tube	208961.8
35	Bandage crepe	Roll	64913.18
36	Bandage gauze non-sterilr	-	201525
37	Cotton wool 500gr	Roll	566237
38	Gauze compress parafine	-	41000
39	Gauze 90cmx91m	-	1128540
40	Medical bags plastic	Piece	380000
			<b>12430164.01</b>

Table A.6 (Continued)

No	Items	Unit	Costs (R)
<b>3rd trimestre</b>			
<i>For inpatient department only</i>			
1	Aminophiline 250mg	Amp.	47559.9
2	Ampicilline 500mg	Flacon	177127.04
3	Atropine sulphate 1mg/ml amp	Amp.	5723.31
4	Bupivacaine 0,5mg/10ml	-	23000
5	Calcium gluconate 10%	-	95485.19
6	Chloramphenicol 1gr	Flacon	242915.15
7	Chloxacilline 1gr	-	351325.25
8	Depoprovra+seringe	-	6840000
9	Dextrose 50% 50ml	-	385776
10	Dopamine 200mg	Amp.	272139.36
11	Ephredrine for dilution	-	61043.27
12	Gentamicine 80 mg/2ml	-	1197757.12
13	Lidocaine 1% 50ml	Flacon	82591.15
14	Metoclopramide 10mg/2ml	Amp.	37246.99
15	Oxytocine 10UI/ml	-	14852.26
16	Penicilline benzathine 2.4MUI	Flacon	111564.24
17	Penicilline injection 1MUI	-	173129.72
18	Penicilline procaine+Pen.G	-	533000
19	Pentazocine 30mg	Amp.	48541.19
20	Potassium chloride 10%	-	11902.84
21	Quinine dihydro.2ml 600mg	-	22000
22	Salbutamol 0.5mg/ml	-	13180.68
23	Sodium bicarbonate 8.4%	-	51012.18
24	Vitamine K 1mg/ml	-	45182.22
25	Dextrose 10% 500ml+set	Bottle	990030
26	Dextrose 5% 500ml+set	-	306000
27	NSS 0,9% 1000ml	-	191200
28	Atropine sulfate 1% coll.5ml	-	31032.69
29	Bags urine coll.with tap 2L	Piece	21986.72
30	Catheter IV 18G	Piece	121725
31	Catheter IV 20G	-	121725
32	Catheter IV 22G	-	121725
33	Condoms 48mm	-	201600
34	Glove surgical sterile/reus 7	Packet	96732
35	Glove surgical sterile/reus 6.5	-	67007.15
36	Glove surgical sterile/reus 7.5	-	152889.14
37	Needle suture cutting assorted	Piece	12984
38	Needle Luer reusable 19g	-	17065.88
39	Needle Luer reusable 21g	-	17065.88
40	Needle Luer reusable 25g	-	17065.88
41	Scalp vein 21-23G	-	13610.83
42	Scalp vein 25G	-	18217.2
43	Sut/nylon	-	178125.61
44	Suture vicryl 3/0-30cm	-	204162.41
45	Suture vicryl 2/0-70cm	-	484964
46	Talc 1kg	-	124300.62
47	Tape umbilical non- sterile	Roll	358383.55

14713653.62

Table A.6 (Continued)

No	Items	Unit	Costs (R)
<b>4th trimester</b>			
<i>For outpatient and inpatient departement</i>			
1	Acetyl salicylic acid 300mg	Tablet	243119.76
2	Amoxilline 250mg	Gellule	1440000
3	Chloramphenicol 250mg	Capsule	231049
4	Chlopromazine 25mg	Tablet	10526.322
5	Cimetidine 200mg	-	273054.12
6	Cloxacilline 250mg	-	152653.62
7	Cotrimoxazole 100+20mg	-	162000
8	Cotrimoxazole 400+80mg	-	1040000
9	Diazepam 5mg	-	26923.74
10	Digoxine 0.5mg	-	15000
11	Ergomethrine Methyl 0.125mg	-	28000
12	Erythromicine 250mg	-	93705.31
13	Furosemide 40mg	-	77477.02
14	Indometacine 25mg	-	84000
15	Mebendazol 100mg	-	252000
16	Mefloquine 250mg	-	226000
17	Methyldopa 250mg	-	89375
18	Metronidazol 250mg	-	181055.34
19	Multivitamines	-	367400.39
20	Niclosamide 500mg	-	30700.5
21	Nystatine 100000UI	Ovule	94647.6
22	O.R.S	Sachet	1121967.77
23	Paracetamol 100mg	Tablet	45196.48
24	Paracetamol 500mg	-	164644.62
25	Phen Meth Penicilline 250mg	Tablet	1471481.81
26	Phenobarbital 50mg	-	12580260
27	Promethazine 25mg	-	187620.032
28	Quinine sulfate 300mg	-	505795.2
29	Tetracycline 250mg	-	106290.08
30	Oxide de zinc 10%	Pot	35265
31	Iode polyvidone 10% 200ml	Flacon	147516.3
32	Tetracycline 1% 5g	Tube	89969.657
33	Bandage crepe	Roll	259600.7
34	Bandage gauze non-sterilr	-	523965
35	Cotton wool 500gr	Roll	683228
36	Gauze compress parafine	-	49200
37	Gauze 90cmx91m	-	1756062
38	Medical bags plastic	-	198606.8
			<b>25045357.17</b>
<i>For inpatient only</i>			
1	Epinephrine/adrenaline	Amp.	15886650
2	Ampicilline 500mg	Flacon	1771270.4
3	Atropine sulfate 1mg/ml	Amp.	22893.24
4	Butylscopalamine 20mg/2ml	-	54213.66
5	Chloramphenicol 1g	Flacon	210526.45
6	Chlorpromazine	Amp.	3029.6

Table A.6 (Continued)

No	Items	Unit	Costs (R)
7	Chloxacilline 1gr	Flacon	1405300.1
8	Depoprovra+seringe	-	1856000
9	Dexamethasone	Amp.	76273.182
10	Dextrose 50% 50ml	Flacon	260398.8
11	Diazepam 10mg/2ml	Amp.	49013.567
12	Digoxine 0.5mg/2ml	-	76046.634
13	Solvent for injection	-	65027.64
14	Ephredrine for dilution	-	61043.266
15	Ergometrine methyl 0.2mg/ml	-	25718.4
16	Furosemide 20mg/2ml	-	11124.18
17	Gentamicine 80 mg/2ml	-	513324.48
18	Hydralazine 20mg/ml	-	31190.305
19	Hydrocortisone 100mg/2ml	-	483666
20	Lidocaine 1% 50ml	Flacon	70721.84
21	Lidocaine 2% 1.8ml	Cart	261117.583
22	Metoclopramide 10mg/2ml	Amp.	7449.398
23	Metronidazol 500mg/100ml	Flacon	56572.543
24	Oxytocine 10UI/ml	Amp.	38370.36
25	Penicilline benzathine 2.4MUI	Flacon	278910.6
26	Penicilline injection1MUI	-	253923.595
27	Penicilline procaine+Pen.G	-	53300
28	Quinine dihydro.2ml 600mg	-	66000
29	Salbutamol 0.5mg/ml	-	21368.52
30	Sodium bicarbonate 8.4%	-	68016.24
31	Vitamine K 1mg/ml	-	45182.21
32	Dextrose 10% 500ml+set	Bottle	511515
33	Dextrose 5% 500ml+set	-	30600
34	Dextran 40+set 500ml	-	192096
35	Chlorex 1.5%+cetrim 15% 5l	Flacon	137000
36	Blades for surgical knife #22	Piece	59368.4
37	Catheter foley CH8	-	116600
38	Catheter foley CH12	-	60520
39	Catheter foley CH14	-	75650
40	Catheter IV 18G	-	122000
41	Catheter IV 20G	-	242098.7
42	Catheter IV 22G	-	219105
43	Condoms 48mm	-	201600
44	Glove surgical sterile/reus 7	Packet	469050.05
45	Glove surgical sterile/reus 6.5	-	268028.6
46	Needle Luer reusable 19g	Piece	23892.237
47	Needle Luer reusable 21g	-	34131.767
48	Needle Luer reusable 25g	-	34131.767
49	Scalp vein 18-20G	-	54650.6
50	Scalp vein 21-23G	-	28200
51	Scalp vein 25G	-	167517
52	Suture catgut	-	393000
53	Sut/nylon	-	534376.84
54	Suture vicryl 3/0-30cm	-	748595.5
55	Syringes glass 5ml	-	216934.5

**Table A.6 (continued)**

No	Items	Unit	Costs (R)
56	Syringes glass 10ml	-	117765.26
57	Syringes glass 20ml	-	34656
58	Talc 1kg	-	326455.05
59	Tape umbilical non-sterile	Roll	1110268.4
60	Thermometer oral	Piece	32544
61	Tubes drain redon	-	22360
62	Tube nasogastric CH5	-	18935
63	Tube nasogastric CH8	-	9900
64	Tube nasogastric CH14	-	32148
65	Fixer powder 10L	-	76953.52
66	Developer powder 10L	-	77738.76
			<b>30884028.74</b>

Total cost of drugs used for both in OPD and IPD = 118779581,1riels

Total cost of drugs keep using for IPD = 69925194,99riels



**Table A.7: Calculate Capital Costs for all divisions in the hospital**

$$P1 = Co(r-i) \left\{ \frac{(1+i)}{(1+r)} \right\}^n / 1 - \left\{ \frac{(1+i)}{(1+r)} \right\}^n$$

i = inflation rate

r = interest rate

No	Items	Life	Cost(R)	Inflation rate	Interest rate	$\left(\frac{(1+i)}{(1+r)}\right)^n$	P1
<b>Pediatrics</b>							
1	Aspirator Ambu, foot operated	10	532602	0.09	0.102	0.90	55235
2	Autoclave vertical	10	202500	0.09	0.102	0.90	21001
3	Baby scale	10	143100	0.09	0.102	0.90	14841
4	Hospital hammock	10	723600	0.09	0.102	0.90	75043
5	Charriot roulante inox	10	1192752	0.09	0.102	0.90	123698
6	Hospital beds	10	3240000	0.09	0.102	0.90	336015
7	Laringoscope	5	189000	0.09	0.102	0.95	40305
8	Otoscope	5	85050	0.09	0.102	0.95	18137
9	Obus oxygene+manometre	10	648000	0.09	0.102	0.90	67203
10	Stand for perfusion	5	950400	0.09	0.102	0.95	202675
11	Resuscitateur	5	409833	0.09	0.102	0.95	87398
12	Examination table	10	693900	0.09	0.102	0.90	71963
13	Infant tensiometre	3	90720	0.09	0.102	0.97	32601
14	Shallow tray	3	33750	0.09	0.102	0.97	12128
15	Tray with cover	3	16632	0.09	0.102	0.97	5977
16	Bassin Kidney	3	31050	0.09	0.102	0.97	11158
17	Bed bassin	3	69255	0.09	0.102	0.97	24888
18	Drum sterilization	3	29160	0.09	0.102	0.97	10479
19	Inox box for 4 seringes	3	82296	0.09	0.102	0.97	29574
20	White board	5	67500	0.09	0.102	0.95	14395
21	Wardrobe	5	108000	0.09	0.102	0.95	23031
22	Writing desk	5	135000	0.09	0.102	0.95	28789
23	Chair	5	162000	0.09	0.102	0.95	34547
24	Bed utility	5	135000	0.09	0.102	0.95	28789
25	Folding screen	5	324000	0.09	0.102	0.95	69094
26	Table	5	94500	0.09	0.102	0.95	20152
27	Stool	5	135000	0.09	0.102	0.95	28789
28	Stove kerogene	2	53190	0.09	0.102	0.98	28830
							<b>1516737</b>
<b>General medicine</b>							
1	Adult scale	10	356400	0.09	0.102	0.90	36962
2	Brancart pliante	10	207441	0.09	0.102	0.90	21513
3	Charriot roulante inox	10	596376	0.09	0.102	0.90	61349
4	Hospital bed	10	567000	0.09	0.102	0.90	588026
5	Otoscope	5	85050	0.09	0.102	0.95	18137
6	Kidney bassin	3	62100	0.09	0.102	0.97	22316
7	bed bassin	3	69255	0.09	0.102	0.97	24888
8	Box aluminium for 4 seringes	3	41148	0.09	0.102	0.97	14787
9	Drum sterilization	3	29160	0.09	0.102	0.97	10479
10	Shallow tray	3	33750	0.09	0.102	0.97	12128
11	Stand for perfusion	5	950400	0.09	0.102	0.95	202675
12	Examination table	10	693900	0.09	0.102	0.90	71963
13	Adult tensiometre	3	81540	0.09	0.102	0.97	29302
14	White board	5	135000	0.09	0.102	0.95	28789

**Table A.7 (Continued)**

No	Items	Life	Cost(R)	Inflation rate	Interest rate	$((1+i)/(1+r))^n$	P1
15	Wardrobe	5	108000	0.09	0.102	0.95	23031
16	Writing desk	5	135000	0.09	0.102	0.95	28789
17	Chair	5	324000	0.09	0.102	0.95	69094
18	Bed utility	5	135000	0.09	0.102	0.95	28789
19	Folding screen	5	648000	0.09	0.102	0.95	138188
20	Table	5	189000	0.09	0.102	0.95	40305
21	Stool	5	270000	0.09	0.102	0.95	57578
							<b>1529590</b>
<b>Gyneco-obstetric</b>							
1	Mucus aspirator foot operated	10	532602	0.09	0.102	0.90	55235
2	Vertical autoclave	10	202500	0.09	0.102	0.90	21001
3	Adult scale	10	356400	0.09	0.102	0.90	36962
4	Baby scale	5	314280	0.09	0.102	0.95	67021
5	Baby scale suspend	5	88857	0.09	0.102	0.95	18949
6	Hospital hamox	10	3618000	0.09	0.102	0.90	375217
7	Bock laveur+tuyaux canule	3	39204	0.09	0.102	0.97	14088
8	clamp ombilical inox	3	71820	0.09	0.102	0.97	25809
9	chariot roulant	10	596376	0.09	0.102	0.90	61849
10	Cranioclaste de Braum	3	26055	0.09	0.102	0.97	9363
11	Cuvette de toilette	3	26514	0.09	0.102	0.97	9528
12	Extractor a vide type Malmstrom	5	1374921	0.09	0.102	0.95	293205
13	Aspirator Aesculap	5	135540	0.09	0.102	0.95	28904
14	Forceps obstetrical Tarnier	3	25110	0.09	0.102	0.97	9024
15	Patient bed	10	1620000	0.09	0.102	0.90	168008
16	Dilatation kit	5	326700	0.09	0.102	0.95	69670
17	Metre ruban 1.5/60 coton	2	1161	0.09	0.102	0.98	629
18	Oxygene bll+detendeur	10	810000	0.09	0.102	0.90	84004
19	Pelvinetre type collyer	3	15363	0.09	0.102	0.97	5521
20	Perce crane Smellie 27cm	2	25650	0.09	0.102	0.98	13903
21	Stand for perfusion	5	475200	0.09	0.102	0.95	101338
22	Resuscitateur adult	5	409833	0.09	0.102	0.95	87398
23	dressng set	3	356400	0.09	0.102	0.97	128077
24	Obstetrical stestoscope	3	65610	0.09	0.102	0.97	23578
25	Delivery table	10	1290600	0.09	0.102	0.90	133846
26	Examination table	10	693900	0.09	0.102	0.90	71963
27	Stove kerosene	2	53190	0.09	0.102	0.98	28830
28	Kidney bassin	3	24840	0.09	0.102	0.97	8927
29	Bed bassin	3	69255	0.09	0.102	0.97	24888
30	Box aluminium for 4 seringes	3	41148	0.09	0.102	0.97	14787
31	Shallow tray	3	33750	0.09	0.102	0.97	12128
32	Tray with cover	3	27864	0.09	0.102	0.97	10013
33	Drum sterilisation	3	14580	0.09	0.102	0.97	5240
34	Tensiometre	3	81540	0.09	0.102	0.97	29302
35	White board	5	67500	0.09	0.102	0.95	14395
36	Wardrobe	5	108000	0.09	0.102	0.95	23031
37	Writing desk	5	135000	0.09	0.102	0.95	28789
38	Chair	5	31000	0.09	0.102	0.95	17273
39	Bed utility	5	135000	0.09	0.102	0.95	28789
40	Folding screen	5	162000	0.09	0.102	0.95	34547
41	Table	5	94500	0.09	0.102	0.95	20152

**Table A.7 (Continued)**

No	Items	Life	Cost(R)	Inflation rate	Interest rate	$((1+i)/(1+r))^n$	P1
42	Stool	5	67500	0.09	0.102	0.95	14395
							<b>2229576</b>
<b>Operating room</b>							
1	Mucus aspirator foot operated	10	532602	0.09	0.102	0.90	55235
2	Anesthesia machine	10	4484700	0.09	0.102	0.90	465101
3	Autoclave universale	10	4725000	0.09	0.102	0.90	490022
4	Electric aspirator	10	3240000	0.09	0.102	0.90	336015
5	Brancard portatif demonte	10	992601	0.09	0.102	0.90	102941
6	Bistori electrique	10	6750000	0.09	0.102	0.90	700032
7	Chariot roulant inox	10	596376	0.09	0.102	0.90	61849
8	Laryngoscope Jeu de 3 lames	5	189000	0.09	0.102	0.95	40305
9	Lamp scialytique	10	6515100	0.09	0.102	0.90	675670
10	Lamp scialytique roulante	10	1263600	0.09	0.102	0.90	131046
11	Stand for drum	5	389934	0.09	0.102	0.95	83154
12	Support cuvette socle	5	211869	0.09	0.102	0.95	45182
13	Support obus	5	313200	0.09	0.102	0.95	66791
14	Negatoscope	5	1371600	0.09	0.102	0.95	292497
15	Operation table	10	3186000	0.09	0.102	0.90	330415
16	Drum Inox	3	210519	0.09	0.102	0.97	75653
17	Anesthesia moving table	10	235170	0.09	0.102	0.90	24389
18	Instrumentif table Mavo	5	172530	0.09	0.102	0.95	36792
							<b>4013089</b>
<b>Surgery</b>							
1	Vertical autoclave	5	202500	0.09	0.102	0.95	43184
2	Boite cesarienne	5	675000	0.09	0.102	0.95	143945
3	Boite hysterectomie	5	1795500	0.09	0.102	0.95	382895
4	Boite laparotonmie	5	2683800	0.09	0.102	0.95	572327
5	Boite amputation	5	1080000	0.09	0.102	0.95	230313
6	Brancard pliante	10	207441	0.09	0.102	0.90	21513
7	Chariot roulante inox	10	596376	0.09	0.102	0.90	61849
8	Patient bed	10	3240000	0.09	0.102	0.90	336015
9	Box for small surgery	5	1512000	0.09	0.102	0.95	322438
10	Oxygene etendeur	5	810000	0.09	0.102	0.95	172735
11	Stand for perfusion	5	1188000	0.09	0.102	0.95	253344
12	Stove kerosene	2	53190	0.09	0.102	0.98	28830
13	Kidney bassin	3	62100	0.09	0.102	0.97	22316
14	bed bassin	3	69255	0.09	0.102	0.97	24888
15	Shallow tray	3	33750	0.09	0.102	0.97	12128
16	Tray with cover	3	13932	0.09	0.102	0.97	5007
17	Drum sterilisation	3	29160	0.09	0.102	0.97	10479
18	Tensiometre	3	81540	0.09	0.102	0.97	29302
19	Examination table	10	693900	0.09	0.102	0.90	71963
20	White board	5	135000	0.09	0.102	0.95	28789
21	Wardrobe	5	108000	0.09	0.102	0.95	23031
22	Writing desk	5	135000	0.09	0.102	0.95	28789
23	Chair	5	324000	0.09	0.102	0.95	69094
24	Bed utility	5	135000	0.09	0.102	0.95	28789
25	Folding screen	5	648000	0.09	0.102	0.95	138188
26	Table	5	189000	0.09	0.102	0.95	40305
27	Stool	5	270000	0.09	0.102	0.95	57578
							<b>3160035</b>

Table A.7 (Continued)

No	Items	Life	Cost(R)	Inflation rate	Interest rate	$((1+i)/(1+r))^n$	P1
<b>Building</b>							
1	From GTZ	20	386499195	0.09	0.102	0.80	18945517
2	From ODA	20	79439400	0.09	0.102	0.80	3893981
<b>22839498</b>							
<b>Reunion</b>							
1	Retroprojector + screen	5	1350000	0.09	0.102	0.95	287891
2	White board	5	135000	0.09	0.102	0.95	28789
3	Wardrobe	5	216000	0.09	0.102	0.95	46063
4	Long chair	5	54000	0.09	0.102	0.95	11516
5	Chair	5	486000	0.09	0.102	0.95	103641
6	Table	5	945000	0.09	0.102	0.95	201524
<b>679423</b>							
<b>Guarde service</b>							
1	White board	5	67500	0.09	0.102	0.95	14395
2	Wardrobe	5	216000	0.09	0.102	0.95	46063
3	Writing desk	5	270000	0.09	0.102	0.95	57578
4	Chair	5	162000	0.09	0.102	0.95	34547
5	Bed utility	5	270000	0.09	0.102	0.95	57578
6	Folding screen	5	81000	0.09	0.102	0.95	17273
7	Hanger dress	5	13500	0.09	0.102	0.95	2879
<b>230313</b>							
<b>Administration</b>							
1	Calculator	3	54000	0.09	0.102	0.97	19406
2	Typing machine	5	1620000	0.09	0.102	0.95	345469
3	Repro stencil	5	1350000	0.09	0.102	0.95	287891
4	White board	5	270000	0.09	0.102	0.95	57578
5	Wardrobe	5	432000	0.09	0.102	0.95	92125
6	Chair	5	162000	0.09	0.102	0.95	34547
7	Writing desk	5	540000	0.09	0.102	0.95	115156
8	Radio communication	10	2970000	0.09	0.102	0.90	308014
9	Bicycle	5	540000	0.09	0.102	0.95	115156
10	Generator 20kv diesel	10	15660000	0.09	0.102	0.90	1624073
11	Generator 5kv	10	2700000	0.09	0.102	0.90	280013
12	Vehicle	10	54000000	0.09	0.102	0.90	56002522
13	Moto supervisor 70cc	10	18900000	0.09	0.102	0.90	1960088
14	Water tape	10	1371600	0.09	0.102	0.90	142246
15	Regulator tension 125 A	10	4860000	0.09	0.102	0.90	504023
16	Public address system	10	1350000	0.09	0.102	0.90	140006
<b>62028314</b>							
<b>Radiology</b>							
1	X-ray machine	10	14785200	0.09	0.102	0.90	1533349
2	Alphabet en plomb	5	162000	0.09	0.102	0.95	34547
3	cuve development film	5	144315	0.09	0.102	0.95	30776
4	Carte porte film 18x24	3	232200	0.09	0.102	0.97	83444
5	Carte porte film 30x40	3	280800	0.09	0.102	0.97	100909
6	Carte porte film 35x43	3	298350	0.09	0.102	0.97	107216
7	Cassette film 18x24	3	850500	0.09	0.102	0.97	305638
8	Cassette film 30x40	3	1018575	0.09	0.102	0.97	366038
9	Cassette film 35x43	3	932850	0.09	0.102	0.97	335231
10	Gant protector	3	55620	0.09	0.102	0.97	19985

Table A.7 (Continued)

No	Items	Life	Cost(R)	Inflation rate	Interest rate	$((1+i)/(1+r))^n$	P1
11	Negatoscope	5	1371600	0.09	0.102	0.95	292497
12	Lunette protector	3	121500	0.09	0.102	0.97	43663
13	Stylo test	3	95175	0.09	0.102	0.97	34202
14	Tablier protector	3	94500	0.09	0.102	0.97	33960
							<b>3321457</b>
<b>Consultation</b>							
1	Adult scale	10	356400	0.09	0.102	0.90	36962
2	Otoscope	5	85050	0.09	0.102	0.95	18137
3	Tensiometre for adult	3	81540	0.09	0.102	0.97	29302
4	Tensiometre for infant	3	90720	0.09	0.102	0.97	32601
5	Speculum nasal	3	11124	0.09	0.102	0.97	3998
6	White board	5	67500	0.09	0.102	0.95	14395
7	Wardrobe	5	216000	0.09	0.102	0.95	46063
8	writing desk	5	135000	0.09	0.102	0.95	28789
9	Chair	5	64800	0.09	0.102	0.95	13819
10	Long Chair	5	81000	0.09	0.102	0.95	17273
11	Folding screen	5	81000	0.09	0.102	0.95	17273
12	Stool	5	13500	0.09	0.102	0.95	2879
13	Dental set 1: DS1 B	5	520074	0.09	0.102	0.95	110907
14	Dental set 2: DS2 B	5	256500	0.09	0.102	0.95	54699
15	Dental set 3: DS3 B	5	271323	0.09	0.102	0.95	57860
16	Dental set 4: DS4 B	5	161892	0.09	0.102	0.95	34524
17	Dental set 5: DS5 B	5	135000	0.09	0.102	0.95	28789
18	Dental set 6: DS6 B	5	2107242	0.09	0.102	0.95	449375
							<b>997645</b>
<b>Laboratory</b>							
1	Anse de plaine	3	9450	0.09	0.102	0.97	3396
2	Balance laboratory	10	945000	0.09	0.102	0.90	98004
3	Ballon a font plat	3	18900	0.09	0.102	0.97	6792
4	Ballon a font plat	3	29700	0.09	0.102	0.97	10673
5	Kidney bassin	3	12420	0.09	0.102	0.97	4463
6	becher	3	8100	0.09	0.102	0.97	2911
7	Boite range lames	3	113400	0.09	0.102	0.97	40752
8	Cellule de Nageotte	3	91800	0.09	0.102	0.97	32989
9	Cellule de Neubauer	3	108000	0.09	0.102	0.97	38811
10	Centrifugeur de table	5	3510000	0.09	0.102	0.95	748516
11	Centrifugeur d'hematocrite	5	3510000	0.09	0.102	0.95	748516
12	Compteur mecanique	5	280800	0.09	0.102	0.95	59881
13	Compteur mecanique de table	5	1512000	0.09	0.102	0.95	322438
14	Cuve a coloration	3	27000	0.09	0.102	0.97	9703
15	Entonnoir	3	113400	0.09	0.102	0.97	40752
16	Eprouvette	3	8100	0.09	0.102	0.97	2911
17	Eprouvette	3	10800	0.09	0.102	0.97	3881
18	Eprouvette	3	21600	0.09	0.102	0.97	7762
19	Water filter	5	270000	0.09	0.102	0.95	57578
20	Fiaule jaugée 100ml	3	13500	0.09	0.102	0.97	4851
21	Fiaule jaugée 500ml	3	27000	0.09	0.102	0.97	9703
22	Flacon compte-goutte	3	24300	0.09	0.102	0.97	8733
23	Flacon pour conservation	3	54000	0.09	0.102	0.97	19406
24	Goupillon pour tubes a essai	3	27000	0.09	0.102	0.97	9703

**Table A.7 (Continued)**

No	Items	Life	Cost(R)	Inflation rate	Interest rate	$((1+i)/(1+r))^n$	P1
25	Goupillon pour tubes a hemolyse	3	5400	0.09	0.102	0.97	1941
26	Hemoglobine de Sallhi	5	75600	0.09	0.102	0.95	16122
27	Lampe a alcool	3	29700	0.09	0.102	0.97	10673
28	Microscope olympis	10	2970000	0.09	0.102	0.90	308014
29	Minuteur mecanique de table	3	97200	0.09	0.102	0.97	34930
30	Mortier+pilon	3	97200	0.09	0.102	0.97	34930
31	Pince a lame	3	54000	0.09	0.102	0.97	19406
32	Regle de lecture hematocrite	5	364500	0.09	0.102	0.95	77731
33	Calculator	3	13500	0.09	0.102	0.97	4851
34	white board	5	67500	0.09	0.102	0.95	14395
35	Wardrobe	5	108000	0.09	0.102	0.95	23031
36	Chair	5	16200	0.09	0.102	0.95	3455
37	Table	5	189000	0.09	0.102	0.95	40305
							<b>2882908</b>
<b>Kitchen</b>							
1	Casseroles 21	3	189000	0.09	0.102	0.97	67920
2	Couscoussier 50l	3	853200	0.09	0.102	0.97	306608
3	Couverts patients	3	459000	0.09	0.102	0.97	164947
4	Faitout 4l	3	91800	0.09	0.102	0.97	32989
5	Faitout 23l	3	178200	0.09	0.102	0.97	64038
6	Lot materiel cuisine	3	216000	0.09	0.102	0.97	77622
7	Bed utility	5	270000	0.09	0.102	0.95	57578
							<b>771703</b>
<b>Pharmacy</b>							
1	Glaciere 27 litres	5	251100	0.09	0.102	0.95	53548
2	Refrigerateur keros	5	3712500	0.09	0.102	0.95	791700
3	Etagere en bois	5	270000	0.09	0.102	0.95	57578
4	Calculator	3	13500	0.09	0.102	0.97	4851
5	White board	5	67500	0.09	0.102	0.95	14395
6	Wardrobe	5	108000	0.09	0.102	0.95	23031
7	Writing desk	5	135000	0.09	0.102	0.95	28789
8	Chair	5	32400	0.09	0.102	0.95	6909
9	Table	5	94500	0.09	0.102	0.95	20152
							<b>1000954</b>

**Table A.8: Step-down Allocation of the Baseline Scenario, only Capital Costs, from NRPPC to RPCC**

No	Divisions	Direct costs	Allo basis (square feet)	Building distribute	Total adm.cost (direct+indirect)	Allo. basis (salary)	Administration distribute	Total clea.cost (direct+indirect)	Allo.basis (squ.feet)	Clean.cost distribute	
<b>NRPPC</b>											
1	Building	<b>22839498</b>	1856.81		<b>66097408</b>			<b>759637</b>			
2	Administration	62028314	330.81	4069094							
3	Cleaning	0	7.8	95943		200560	663694				
4	Guard	230313	46.57	572829		841044	2783185			46.57	23301
5	Reunion and training	679423	48.88	601243		0	0			48.88	24457
<b>RPCC</b>											
<i>Intermediate cost center</i>											
1	Pharmacy	1000954	30.75	378237		1641104	5430747		30.75	15386	
2	Laboratory	2882908	46.58	572952		1282276	4243312		46.58	23306	
3	Radiology	3321457	41.6	511696		364060	1204749		41.6	20815	
<i>Patient services</i>											
<b>Outpatient</b>											
1	Consultation	997645	246.28	3029341		1503851	4976549		246.28	123227	
<b>Inpatient</b>											
1	General medicine	1529590	157.5	1937312		3083130	10202705		157.5	78806	
2	Pediatric	1516737	157.5	1937312		2385094	7892761		157.5	78806	
3	Emergency and surgery	7173124	472.3	5809477		5372392	17778337		472.3	236317	
4	Gyneco-obstetric	2229576	222.44	2736100		2999462	9925829		222.44	111299	
5	Kitchen	771703	40	492016		100280	331847		40	20014	
6	Laundry	0	7.8	95943		200560	663694		7.8	3903	
<b>Total</b>			<b>1856.81</b>	<b>22839498</b>		<b>19973814</b>	<b>66097408</b>		<b>1518.2</b>	<b>759637</b>	

**Table A.8 (Continued)**

No	Divisions	Direct costs	Building distribute	Administra redistribute	Clean.cos distribute	Total guard (direct+indi	Allo.basis square fee	Guard cost distribute	Tot.reunion (dire.+indir)	Allo.basis # of staff	Reunion distribute		
<b>NRPCC</b>													
4	Guard	230313	572829	2783185	23301	<b>3609629</b>			<b>1425017</b>				
5	Reunion and training	679423	601243	0	24457		48.88	119893					
<b>RPCC</b>													
<i>Intermediate cost center</i>													
1	Pharmacy	1000954	378237	5430747	15386		30.75	75424		5	106345		
2	Laboratory	2882908	572952	4243312	23306		46.58	114252		4	85076		
3	Radiology	3321457	511696	1204749	20815		41.6	102037		1	21269		
<i>Patient services</i>													
<b>Outpatient</b>													
1	Consultation	997645	3029341	4976549	123227		246.28	604078		8	170151		
<b>Inpatient</b>													
1	General medecine	1529590	1937312	10202705	78806	157.5	386318	9	191420				
2	Pediatric	1516737	1937312	7892761	78806	157.5	386318	7	148882				
3	Emergency and sur	7173124	5809477	17778337	236317	472.3	1158462	16	340303				
4	Gyneco-obstetric	2229576	2736100	9925829	111299	222.44	545603	10	212689				
5	Kitchen	771703	492016	331847	20014	40	98112	3	63807				
6	Laundry	0	95943	663694	3903	7.8	19132	4	85076				
<b>Total</b>							<b>1471.63</b>	<b>3609629</b>		<b>1425017.01</b>			



**Table A.8 (Continued)**

**Step- down Allocation of the Baseline Scenario, only Recurrent Cost excluding Labor Cost, from NRPC to RPCC**

No	Divisions	Direct costs	Allo.basis (square feet)	Building distribute	Total adm.cost (direct+indirect)	Allo. basis (salary)	Administration distribute	Total clea.cost (direct+indirect)	Allo.basis (squ. feet)	Clean.cost distribute	
<b>NRPC</b>											
1	Building	<b>223450</b>	1856.81		<b>12914770</b>			<b>1331035</b>			
2	Administration	12874960	330.81	39810							
3	Cleaning	1200417	7.8	939		200560	129679				
4	Guard	262472	46.57	5604		841044	543807			46.57	40829
5	Reunion and training	44145	48.88	5882		0	0			48.88	42854
<b>RPCC</b>											
<i>Intermediate cost center</i>											
1	Pharmacy	31065	30.75	3700		1641104	1061113		30.75	26959	
2	Laboratory	1913139	46.58	5605		1282276	829101		46.58	40838	
3	Radiology	2205885	41.6	5006		364060	235396		41.6	36472	
<i>Patient services</i>											
<b>Outpatient</b>											
1	Consultation	82698	246.28	29638		1503851	972368		246.28	215918	
<b>Inpatient</b>											
1	General medicine	311987	157.5	18954		3083130	1993506		157.5	138083	
2	Pediatric	191854	157.5	18954		2385094	1542166		157.5	138083	
3	Emergency and surgery	612968	472.3	56837		5372392	3473709		472.3	414074	
4	Gyneco-obstetric	278349	222.44	26769		2999462	1939407		222.44	195017	
5	Kitchen	7891055	40	4814		100280	64840		40	35069	
6	Laundry	340625	7.8	939		200560	129679		7.8	6838	
<b>Total</b>			<b>1856.81</b>	<b>223450</b>		<b>19973814</b>	<b>12914770</b>		<b>1518.2</b>	<b>1331035</b>	

**Table A.8 (Continued)**

No	Unit	Direct costs	Building distribute	Administra. distribute	Clean.cos distribute	Total guard (direct+indi)	Allo. basis square fee	Guard cost distribute	Tot.reunion (dire.+indir)	Allo. basis # of staff	Reunion distribute		
<b>NRPCC</b>													
4	Guard	262472	5604.27	543807	40829	<b>852712</b>			<b>121204</b>				
5	Reunion and training	44145	5882.26	0	42854		48.88	28323					
<b>RPCC</b>													
<i>Intermediate cost center</i>													
1	Pharmacy	31065	3700.48	1061113	26959		30.75	17818			5	9045	
2	Laboratory	1913139	5605.47	829101	40838	46.58	26990		4	7236			
3	Radiology	2205885	5006.18	235396	36472	41.6	24104		1	1809			
<b>Patient services</b>													
<b>Outpatient</b>													
1	Consultation	82698	29637.53	972368	215918	246.28	142703		8	14472			
<b>Inpatient</b>													
1	General medecine	311987	18953.68	1993506	138083	157.5	91261		9	16281			
2	Pediatric	191854	18953.68	1542166	138083	157.5	91261		7	12663			
3	Emergency and sur	612968	56836.96	3473709	414074	472.3	273666		16	28944			
4	Gyneco-obstetric	278349	26768.61	1939407	195017	222.44	128889		10	18090			
5	Kitchen	7891055	4813.63	64840	35069	40	23177		3	5427			
6	Laundry	340625	938.66	129679	6838	7.8	4520		4	7236			
<b>Total</b>							<b>1471.63</b>	<b>852712</b>			<b>121203.987</b>		

**Table A.9: Step-down Allocation of the Baseline Scenario from IC to FCC for Capital Cost and then for Recurrent Cost**

Allocate the intermediate cost center, only capital cost, to patient service

No	Divisions	Direct costs	Building distribute	Adminis. distribute	Cleaning distribute	Guard distribute	Reunion distribute	Subtotal (direct+indir.)	Allo.basis			Pharmacy distribute	Laboratory distribute	Radiology distribute
									# of lab.t.	# of x-ray t.	Time			
<i>Intermediate costs center</i>														
1	Pharmacy	1000954	378237	5430747	15386	75424	106345	<b>7007092.13</b>						
2	Laboratory	2882908	572952	4243312	23306	114252	85076	<b>7921806.31</b>						
3	Radiology	3321457	511696	1204749	20815	102037	21269	<b>5182022.52</b>						
<i>Patient services</i>														
1	Outpatient								18009	981	1	1167849	6142154	2197822.8
2	Inpatient								5218	1332	5	5839243	1779652	2984200
<b>Total</b>									<b>23227</b>	<b>2313</b>	<b>6</b>	<b>7007092</b>	<b>7921806.3</b>	<b>5182023</b>

Allocate intermediate cost center, only recurrent costs excluding labor costs, to patient service

No	Divisions	Direct costs	Building distribute	Adminis. distribute	Cleaning distribute	Guard distribute	Reunion distribute	Subtotal (direct+indir.)	Allo.basis			Pharmacy distribute	Laboratory distribute	Radiology distribute
									# of lab.t.	# of x-ray t.	Time			
<i>Intermediate costs center</i>														
1	Pharmacy	31065	3700	1061113	26959	17818	9045	<b>1149700.61</b>						
2	Laboratory	1913139	5605	829101	40838	26990	7236	<b>2822909.14</b>						
3	Radiology	2205885	5006	235396	36472	24104	1809	<b>2508672.01</b>						
<i>Patient services</i>														
1	Outpatient								18009	981	1	191617	2188736	1063989
2	Inpatient								5218	1332	5	958084	634173	1444683
<b>Total</b>									<b>23227</b>	<b>2313</b>	<b>6</b>	<b>1149701</b>	<b>2822909.1</b>	<b>2508672</b>

**Table A.10: Reassignment of Salary and Bonus after Giving Incentive to the Personnel**

The following tables showed the salary bonus and incentive per year of the personnel needing to be assigned to others costs center where they shared with.

**Total salary bonus and incentive per year**

No	Personnel	Number of staff	Salary per month	Incentive per month	Salary and incentive per year	Bonus per year	Subtotal per year
1	Director	1	38000	150000	2256000	10000	2266000
2	Vice director 1	1	38000	120000	1896000	10000	1906000
3	Vice director 2	1	38000	120000	1896000	10000	1906000
4	Doctor A	1	32100	90000	1465200	10000	1475200
5	Doctor B	1	32100	90000	1465200	10000	1475200

**Assignment of salary, bonus and incentive of the personnel to others cost center**

No	Personnel	Salary to be assigned	Cost center													
			Adm.		Emergency		Gynico.obs.		Surgery		General med.		Pediatric		Consultation	
			Activi	Cost	Acti.	Cost	Acti.	Cost	Acti.	Cost	Acti.	Cost	Acti.	Cost	Acti.	Cost
1	Director	2266000	50%	1133000	30%	679800									20%	453200
2	Vice Director 1	1906000	30%	571800			50%	233000							20%	381200
3	Vice Director 2	1906000	30%	571800				953000	50%	953000					20%	381200
4	Doctor A	1475200									80%	1180160			20%	295040
5	Doctor B	1475200											80%	1180160	20%	295040

**Table A.11: New Salary of the Personnel in each Division**

Personnel	No of Staff	Salary/month per person	Incentive per month/person	Salary and incentive/m	Salary and incentive/y	Bonus	Subtotal/year
<b>Administration</b>							
Director							1133000
1st Vice Director							571800
2nd Vice director							571800
Medical assist.	1	32100	70000	102100	1225200	10000	1235200
Staff	7	24700	30000	382900	4594800	70000	4664800
Driver	1	20600	30000	50600	607200	10000	617200
							<b>8793800</b>
<b>Guard</b>	3	20600	30000	151800	1821600	30000	<b>1851600</b>
<b>Küchen staff</b>	2	3000	30000	66000	792000	20000	<b>812000</b>
<b>Cleaner</b>	4	3000	30000	132000	1584000	40000	<b>1624000</b>
<b>Laundry staff</b>	4	3000	30000	132000	1584000	40000	<b>1624000</b>
<b>General medicine</b>							
Doctor A							1180160
Nurse 2	4	27000	50000	308000	3696000	40000	3736000
Nurse 1	3	24700	50000	224100	2689200	30000	2719200
Ancilliary	1	20600	30000	50600	607200	10000	617200
							<b>8252560</b>
<b>Pediatric</b>							
Doctor B	1						1180160
Nurse 2	3	27000	50000	231000	2772000	30000	2802000
Nurse 1	2	24700	50000	149400	1792800	20000	1812800
Ancilliary	1	20600	30000	50600	607200	10000	617200
							<b>6412160</b>
<b>Emergency</b>							
Director							679800
Nurse 2	4	27000	50000	308000	3696000	40000	3736000
Nurse 1	1	20600	50000	70600	847200	10000	857200
							<b>5273000</b>
<b>Gyneco-obstetric</b>							
1st Vice director							953000
Midwife 1.1	2	27000	50000	154000	1848000	20000	1868000
Midwife 1	3	22000	50000	216000	2592000	30000	2622000
Ancilliary	4	20600	30000	202400	2428800	40000	2468800
							<b>7911800</b>
<b>Surgery</b>							
2nd Vice Director							953000
Surgical tech.2	2	32100	70000	204200	2450400	20000	2470400
Nurse 1.1	1	27000	50000	77000	924000	10000	934000
Surgical tech. 1	6	24700	50000	448200	5378400	60000	5438400
							<b>9795800</b>
<b>Laboratory</b>							
Tech.labo 1	3	24700	50000	224100	2689200	30000	2719200
Ancilliary	1	20600	30000	50600	607200	10000	617200
							<b>3336400</b>
<b>Radiology</b>							
Techni.Rx 1 1	1	27000	50000	77000	924000	10000	<b>934000</b>



**Table A.12: New Recurrent Cost after Giving Incentive to the Personnel**

No	Items	Cost (Riel)	Inflation rate	Present values (Riel)
<b>Pediatrics</b>				
1	Material costs	176013	0.09	191854
2	New labor	<b>6412160</b>	0.09	<b>6989254</b>
				<b>7181109</b>
<b>General medicine</b>				
1	Material cost	286227	0.09	311987
2	New labor	<b>8252560</b>	0.09	<b>8995290</b>
				<b>9307278</b>
<b>Gyneco-obstetric</b>				
1	Material costs	255366	0.09	<b>278349</b>
2	New labor	<b>7911800</b>	0.09	<b>8623862</b>
				<b>8902211</b>
<b>Surgery</b>				
1	Material costs	431568		470409
2	New labor(emergency+surgery)	<b>15068800</b>	0.09	<b>16424992</b>
				<b>16895401</b>
<b>Operating room</b>				
1	Material cost			<b>142559</b>
<b>Kitchen</b>				
1	Material cost	7239500	0.09	7891055
2	New labor	<b>812000</b>	0.09	<b>885080</b>
				<b>8776135</b>
<b>Pharmacy</b>				
1	Material cost	28500		31065
2	New labor	<b>4505600</b>	0.09	<b>4911104</b>
3	Drug costs	182931136	0.09	<b>199394938</b>
				204337107
<b>Building</b>				
	Maintenance from government only	205000	0.09	223450
				<b>223450</b>
<b>Reunion</b>				
1	Stationary costs for internal training	27000	0.09	29430
2	Hanger dress	13500	0.09	14715
				<b>44145</b>
<b>Guarde service</b>				
1	Security and safety materials	240800	0.09	262472
2	New labor	<b>1851600</b>	0.09	<b>2018244</b>
				<b>2280716</b>
<b>Cleaning</b>				
1	Cleaning materials	1101300	0.09	1200417
2	New labor	<b>1624000</b>	0.09	<b>1770160</b>
				<b>2970577</b>
<b>Laundry</b>				
1	Laundry materials	312500	0.09	340625
2	Labor	<b>1624000</b>	0.09	<b>1770160</b>
				<b>2110785</b>

**Table A.12 (Continued)**

No	Items	Cost (R) (Po)	Inflation rate	Present values $P1=Po(1+i)$
<b>Radiology</b>				
1	Material cost	2023747.81	0.09	2205885
2	New labor	<b>934000</b>	0.09	1018060
				<b>3223945</b>
<b>Laboratory</b>				
1	Material cost	1755173.84	0.09	1913139
2	New labor	<b>3336400</b>	0.09	<b>3636676</b>
				<b>5549815</b>
<b>Consultation</b>				
1	Material cost	75870	0.09	82698
2	New labor	<b>4787680</b>	0.09	<b>5218571</b>
				<b>5301270</b>
<b>Administration</b>				
1	Material cost	11811890	0.09	12874960
2	New labor	<b>8793800</b>	0.09	<b>9585242</b>
				<b>22460202</b>



**Table A.13: Total Costs (capital+recurrent) of all Divisions in the District  
After Adding Incentive to the Personnel**

Costs center	Capital costs (riel)	Recurrent costs (riel)	Labor costs (riel)	Subtotal (riel)
<b>I-NRPCC</b>				
1-Building	22839498	223450	0	23062948
2-Administration	62028314	12874960	9585242	84488516
3-Cleaning	0	1200417	1770160	2970577
4-Guard	230313	262472	2018244	2511029
5-Reunion and training	679423	44145	0	723568
6-Kitchen	771703	7891055	885080	9547838
7-Laundry	0	340625	1770160	2110785
<b>II-RPCC</b>				
<i>A-Intermediate Cost center</i>				
1-Pharmacy	1000954	31065	4911104	5943123
2-Laboratory	2882908	1913139	3636676	8432723
3-Radiology	3321457	2205885	1018060	6545402
<i>B-Patient service</i>				
<i>a-Outpatient</i>				
1-Consultation	997645	82698	5218571	6298915
2-Drug		103575795		103575795
<i>b-Inpatient</i>				
1-General medicine	1529590	311987	8995290	10836868
2-Pediatric	1516737	191854	6989254	8697846
3-Emergency and surgery	7173124	612968	16424992	24211084
4-Gyneco-obstetric	2229576	278349	8623862	11131787
5-Drug		95819144		95819144
	<b>107201242</b>	<b>227860008,9</b>	<b>71846696</b>	<b>406907946,9</b>

**Table A.14: Step- down Allocation from NRPC to RPCC when the Personnel are Given Incentive**

No	Divisions	Direct costs	Allo.basis (square feet)	Building distribute	Total adm.cost (direct+indirect)	Allo. basis (salary)	Administration distribute	Total clea.cost (direct+indirect)	Allo.basis (squ.feet)	Clean.cost distribute	
<b>NRPCC</b>					<b>88597420</b>			<b>5586379</b>			
1	Building	<b>23062948</b>	1856.81								
2	Administration	84488516	330.81	4108904							
3	Cleaning	2970577	7.8	96882		1770160	2518920				
4	Guard	2511029	46.57	578434		2018244	2871941			46.57	171359
5	Reunion and training	723568	48.88	607126	0	0		48.88	179859		
<b>RPCC</b>											
<i>Intermediate cost center</i>											
1	Pharmacy	5943123	30.75	381938	4911104	6988451		30.75	113148		
2	Laboratory	8432723	46.58	578558	3636676	5174953		46.58	171396		
3	Radiology	6545402	41.6	516703	1018060	1448689		41.6	153072		
<i>Patient services</i>											
<b>Outpatient</b>											
1	Consultation	6298915	246.28	3058979	5218571	7425974		246.28	906213		
<b>Inpatient</b>											
1	General medicine	10836868	157.5	1956266	8995290	12800207		157.5	579538		
2	Pediatric	8697846	157.5	1956266	6989254	9945638		157.5	579538		
3	Emergency and surgery	24211084	472.3	5866314	16424992	23372598		472.3	1737878		
4	Gyneco-obstetric	11131787	222.44	2762869	8623862	12271668		222.44	818492		
5	Kitchen	9547838	40	496829	885080	1259460		40	147184		
6	Laundry	2110785	7.8	96882	1770160	2518920		7.8	28701		
<b>Total</b>			<b>1856.81</b>	<b>23062948</b>		<b>62261454</b>	<b>88597420</b>		<b>1518.2</b>	<b>5586379</b>	

Table A.14 (Continued)

No	Divisions	Direct costs	Building distribute	Administra. distribute	Clean.cos distribute	Total guard (direct+indi	Allo.basis square fee	Guard cost distribute	Tot.reunion (dire.+indir	Allo.basis # of staff	Reunion distribute		
<b>NRPCC</b>													
4	Guard	2511029	578434	2871941	171359	<b>6132763</b>			<b>1714252</b>				
5	Reunion and training	723568	607126	0	179859		48.88	203699					
<b>RPCC</b>													
<i>Intermediate cost center</i>													
1	Pharmacy	5943123	381938	6988451	113148		30.75	128145			5	127929	
2	Laboratory	8432723	578558	5174953	171396	46.58	194114		4	102343			
3	Radiology	6545402	516703	1448689	153072	41.6	173361		1	25586			
<b>Patient services</b>													
<b>Outpatient</b>													
1	Consultation	6298915	3058979	7425974	906213	246.28	1026329		8	204687			
<b>Inpatient</b>													
1	General medicine	10836868	1956266	12800207	579538	157.5	656354		9	230273			
2	Pediatric	8697846	1956266	9945638	579538	157.5	656354		7	179101			
3	Emergency and sur	24211084	5866314	23372598	1737878	472.3	1968228		16	409374			
4	Gyneco-obstetric	11131787	2762869	12271668	818492	222.44	926980		10	255858			
5	Kitchen	9547838	496829	1259460	147184	40	166693		3	76758			
6	Laundry	2110785	96882	2518920	28701	7.8	32505		4	102343			
<b>Total</b>							1471.63	<b>6132763</b>			<b>1714251.69</b>		

**Table A.15: Step-down Allocation from IC to FCC When the Personnel are given Incentive**

No	Divisions	Direct costs	Building distribute	Adminis. distribute	Cleaning distribute	Guard distribute	Reunion distribute	Subtotal (direct+indir.)	Allo.basis			Pharmacy distribute	Laboratory distribute	Radiology distribute
									# of lab. te	# of x-ray te	Time			
<b>Intermediate costs center</b>														
1	Pharmacy	5943123	381938	6988451	113148	128145	127929	<b>13682734.4</b>						
2	Laboratory	8432723	578558	5174953	171396	194114	102343	<b>14654087.6</b>						
3	Radiology	6545402	516703	1448689	153072	173361	25586	<b>8862812</b>						
<b>Patient services</b>														
1	Outpatient								18009	981	1	2280456	11362012	3758936
2	Inpatient								5218	1332	5	11402279	3292075	5103876
<b>Total</b>									<b>23227</b>	<b>2313</b>	<b>6</b>	<b>13682734</b>	<b>14654088</b>	<b>8862812</b>

## APPENDIX B

**Table B.1: Incentive for each Level of Personnel Received each Month at the Routine Laboratory of the National Institute of Public Health**

Personnel	Incentive (Riel)
Director	150,000
Vice director	120,000
Doctor	90,000
Medical assistant	70,000
Midwife/nurse/lab technician	50,000
Ancillary/other staff	30,000

**Table B.2: Total Number of Laboratory Test 1997**

Almost of laboratory tests were direct test

No	Items	OPD	IPD
1	Haemoglobin estimation	920	56
2	Haemotocrit estimation	920	306
3	Blood grouping	504	690
4	Creatinine estimation	216	32
5	Urea estimation	486	12
6	Stool parasitology	275	117
7	CSF examination	609	35
8	Pregnancy test	256	0
9	Aspirated fluid examination	23	24
10	Genital specimen examination	953	89
11	Leucocyte differential	105	52
12	Malaria examination	5131	125
13	Red cell morphology	921	386
14	Platelet count	256	890
15	Reticulocyte count	921	359
16	Leucocyte count	921	386
17	AFB examination	932	108
18	Syphilis serology	439	88
19	Typhoid serology	1308	321
20	Erythrocyte sedimentation rate	921	183
21	Blood coagulation (APTT)	26	102
22	Blood coagulation (PT)	26	690
23	Bilirubine estimation	82	34
24	Urine estimation	357	107
25	Blood glucose estimation	501	26
	<b>Subtotal</b>	<b>18009</b>	<b>5218</b>

**Table B.3: Total Number of X-ray Test 1997**

All of radiology test were general, radiography

No	Items	OPD	IPD
1	Lung	299	515
2	Chest	182	58
3	Heart	216	72
4	Mastoid	24	21
5	Vertebral colum	101	39
6	Leg	36	45
7	Femur	47	61
8	Foot	3	71
9	Hand	19	53
10	Knee	9	16
11	Humerus	27	8
12	Clavicle	18	21
13	Forearm	0	5
14	Arm	0	13
15	Wrist	0	16
16	Sternoclavicular	0	4
17	Oesophagus	0	41
18	Abdomen	0	59
19	Hysterosalpingography	0	72
20	Cystography	0	78
21	Sternum	0	57
22	Scapula	0	7
	Subtotal	981	1332

**Table B.4: Existing Plan of Nakloeung District Hospital**

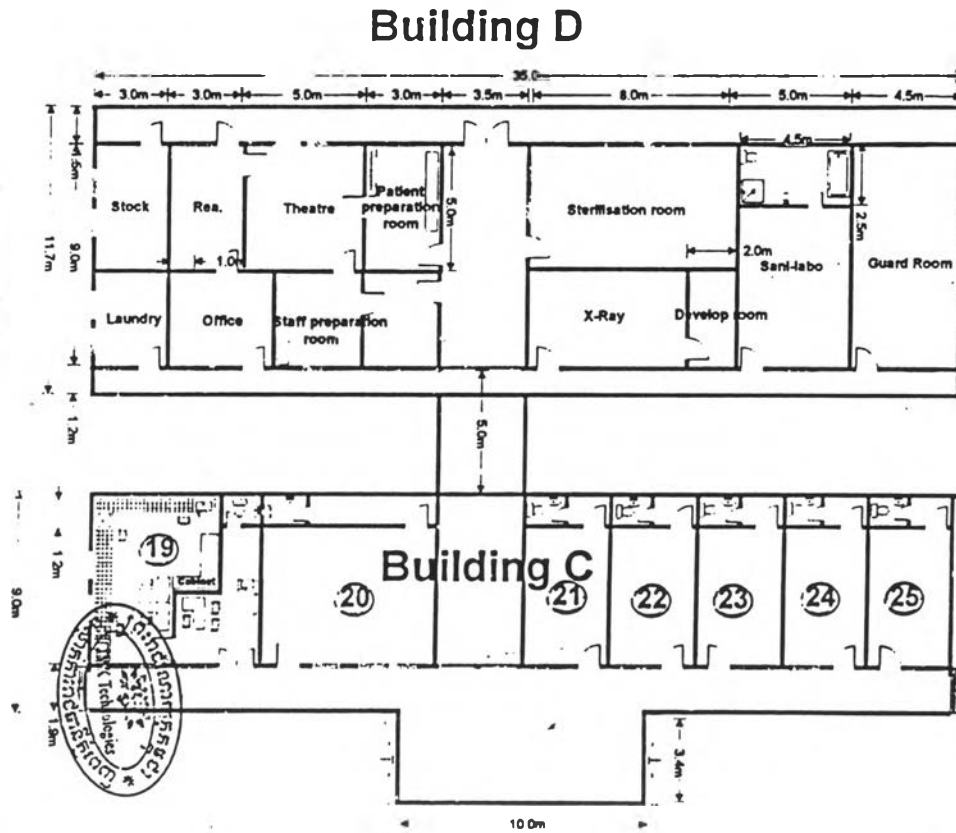
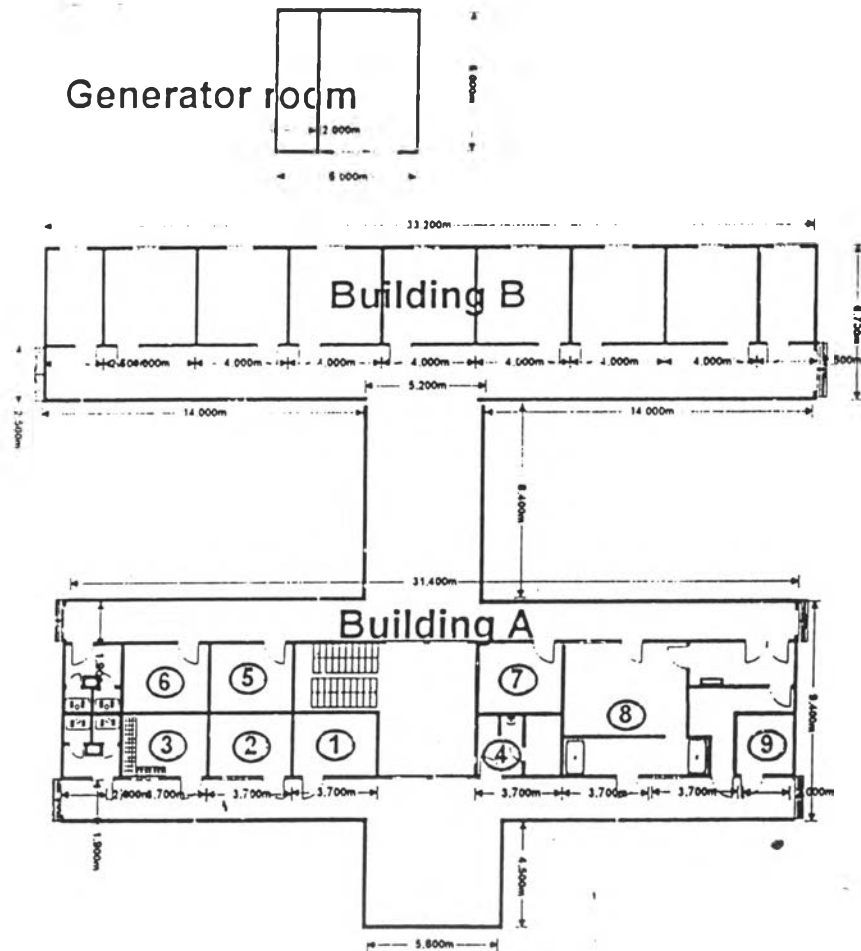



## CURRICULUM VITAE

- |                      |  |
|----------------------|--|
| 1. Name              | Chan Sorya   |
| 2. Sex               | Female   |
| 3. Date of Birth     | August 14, 1963  |
| 4. Nationality       | Cambodian  |
| 5. Marital Status    | Married  |
| 6. Language          | English, French and Cambodian  |
| 7. Address           | National Institute of Public Health, Street Kim Yl<br>Song, Khan Toulkok   |
| 8. Education         | -1982 Matriculation<br><br>-1982-7988 Doctor in Medicine, Faculty of<br>Medicine   |
| 9. Employment Record | 1988-1890: Chief of Gyneco-Obstetric Division in<br>Seam Reap Provincial Hospital<br><br>1990-1993: Chief of Railway Dispensary, Railway<br>Company, Ministry of Transport.<br><br>1993-1997: Chief of Laboratory Routine in National<br>Institute of Public Health. |

